



## A LEGACY / MEMORIAL / REFLECTION PARK

From the Trustees...

The Legacy / Memorial / Reflection Park project seeks to provide current and future generations of Masons the opportunity to provide for a legacy of their own through a physical and enduring structure that further builds on previous generations' charitable giving. This project will therefore be advanced by future Legacy gifts.

MAINE MASONIC CHARITABLE FOUNDATION  
A LEGACY / MEMORIAL / REFLECTION PARK

**HONORING THE...**

**PAST**

**PRESENT**

**FUTURE**

**A CELEBRATION** OF FREEMASONRY IN MAINE - OVER TWO  
CENTURIES OF GOOD MEN WORKING TO BE BETTER MEN.

THIS LEGACY PARK OFFERS A PLACE TO HONOR AND REMEMBER  
MASONS AND FAMILY MEMBERS THAT HAVE HELPED GUIDE MASONS  
IN THEIR LIFE'S JOURNEY

MAINE MASONIC CHARITABLE FOUNDATION  
A LEGACY / MEMORIAL / REFLECTION PARK

THE TRUSTEES APPROVED PROCEEDING WITH A PLAN TO EXPLORE  
CONSTRUCTING A STRUCTURE ON THE FOUNDATION'S PROPERTY IN  
**HOLDEN, MAINE**

A CENTRAL LOCATION FOR MAINE MASONS AND A WELL TRAVELED  
ROAD FOR VISITORS

**63% OF MAINE MASONS LIVE WITHIN 2 HOURS OF HOLDEN**

THE TRUSTEES APPROVED PROCEEDING **ONLY** IF ALL FUNDING FOR THE PROJECT  
CAME FROM NEW FUNDS RAISED BY THE FOUNDATION

# MAINE MASONIC CHARITABLE FOUNDATION

## A LEGACY / MEMORIAL / REFLECTION PARK

Proposed location layout





# MAINE MASONIC CHARITABLE FOUNDATION

A LEGACY / MEMORIAL / REFLECTION PARK

Proposed Structural Plan

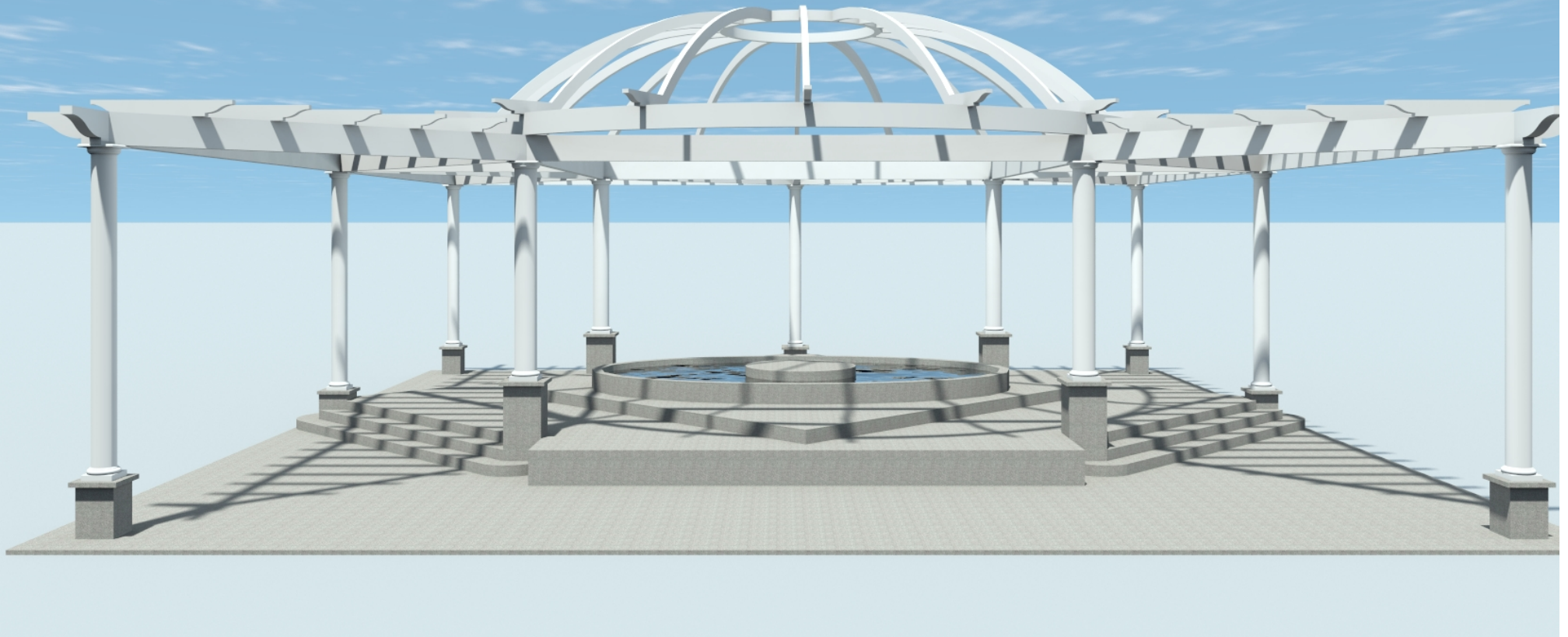

**HONOR A MASON THAT  
CHANGED YOUR LIFE**

**MEMORIALIZE YOUR LODGE AND THE  
GENERATIONS OF MASONS  
PAST, PRESENT & FUTURE**

**MAKE A DEDICATION TO  
YOUR LOVED ONES**



# MAINE MASONIC CHARITABLE FOUNDATION

## A LEGACY / MEMORIAL / REFLECTION PARK

### Proposed Structural Plan





# MAINE MASONIC CHARITABLE FOUNDATION

## A LEGACY / MEMORIAL / REFLECTION PARK

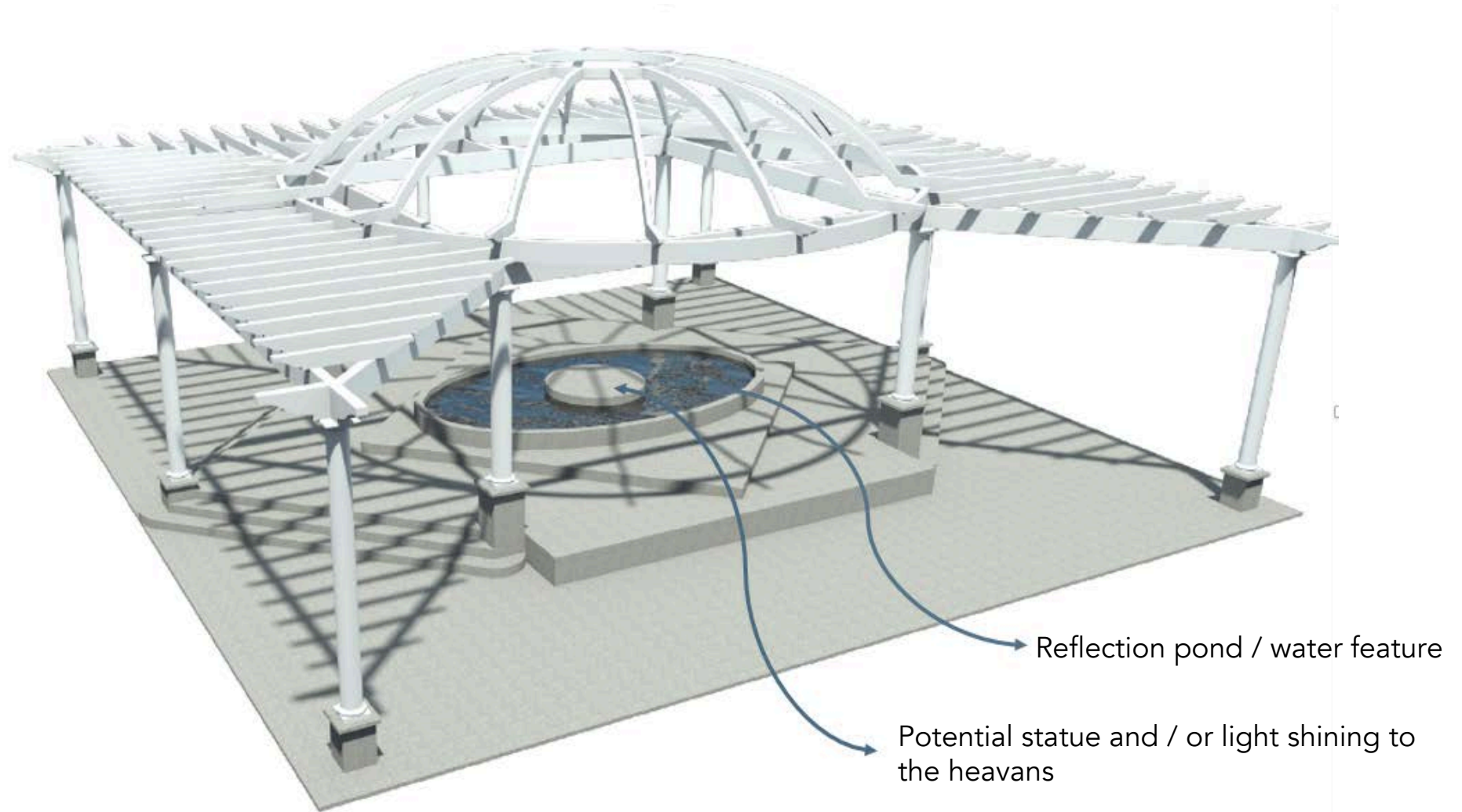

Total footprint = 2500 sq ft

# MAINE MASONIC CHARITABLE FOUNDATION

## A LEGACY / MEMORIAL / REFLECTION PARK

### BIRD'S EYE VIEW

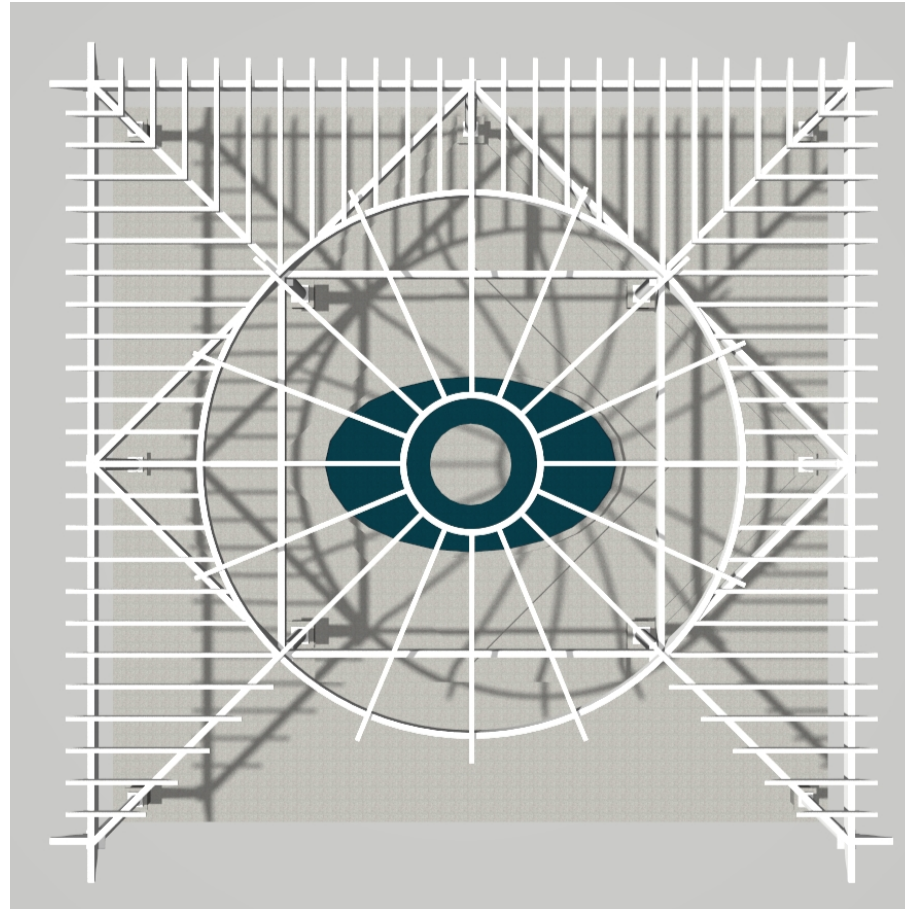

Designed by a Mason to include some subtle and not so subtle layers of Masonic Symbolism



# MAINE MASONIC CHARITABLE FOUNDATION

A LEGACY / MEMORIAL / REFLECTION PARK

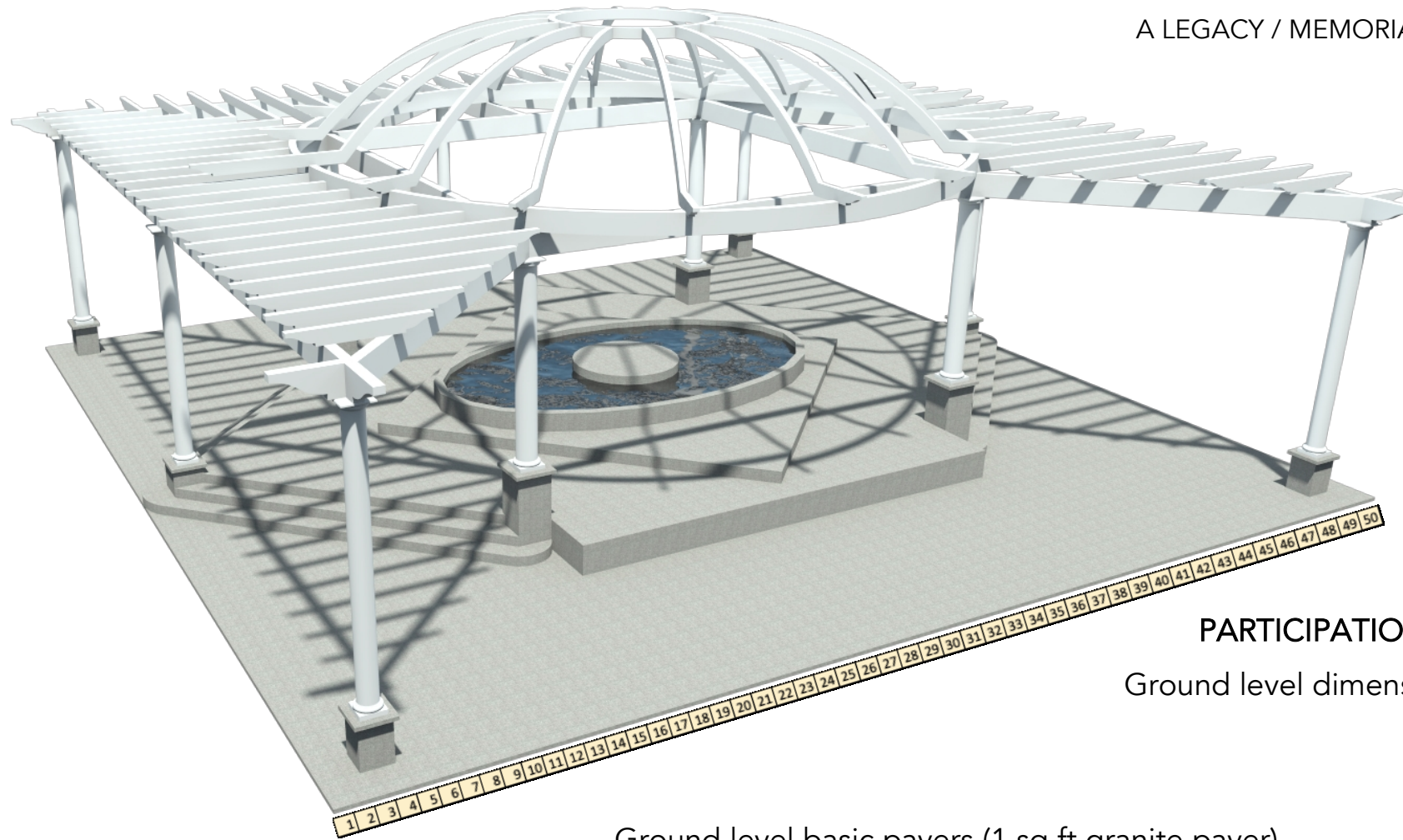

## PARTICIPATION OPTIONS

Ground level dimensions are 50' x 50'

|   |                        |
|---|------------------------|
| • Ground level basic pavers (1 sq ft granite paver) | \$2,500                |
| • Upper level granite pieces (steps and risers)     | \$7,500 to \$15,000    |
| • Pond/Reservoir/Lighting                           | \$100,000 to \$200,000 |
| • Pillars and pillar bases                          | \$50,000 to \$75,000   |
| • Naming rights                                     | \$250,000 to \$600,000 |
| • Trees   | \$7,500                |
| • Benches   | \$7,500 to \$10,000    |

**MAINE MASONIC CHARITABLE FOUNDATION**  
**A LEGACY / MEMORIAL / REFLECTION PARK**

**CELEBRATE ONES OWN INDIVIDUAL JOURNEY**

**PAY TRIBUTE TO THOSE THAT PROVIDED INSPIRATION, DEMONSTRATED  
SELFLESSNESS AND / OR SHOWED TRUE LEADERSHIP**

**RECOGNIZE THE PERSONAL AND GENERATIONAL SIGNIFICANCE OF PAST &  
PRESENT MASONS**

**SUPPORT YOUR FOUNDATION**

# MAINE MASONIC CHARITABLE FOUNDATION

## A LEGACY / MEMORIAL / REFLECTION PARK

### FAQs

1. Who will this be open to?
  - Lodges, Masonic appendant bodies, individual Masons and their families
  - We want to share the plan with everyone (all Masons in Maine) to give equal opportunity to all for the unique opportunities available
2. How long will construction take (once fully funded)?
  - From start to finish six (6) months
3. Is the intention that this "park" will be open year-round to visitors?
  - No, the plan would be for it to open in mid-to-late April and close late October. No plans to shovel or remove snow to allow access (due in part to potential liability and annual maintenance cost concerns)
4. Who do you contact to learn more?
  - The Executive Director (Susan Scacchi)  
[director@mainemcf.org](mailto:director@mainemcf.org) or (603) 677-2436